

SISTEMA FORMA + CHEO/CHEO EVO fissaggio a soffitto/ceiling fixing

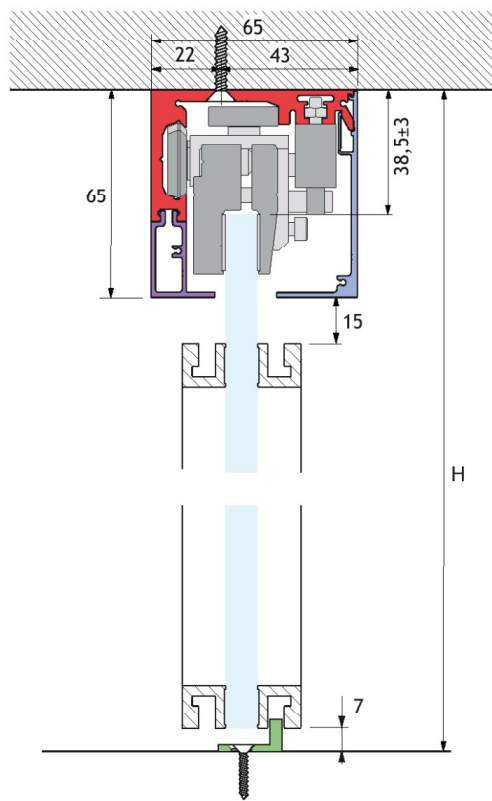

Fissaggio a soffitto senza vetro fisso/ceiling fixing without side glass

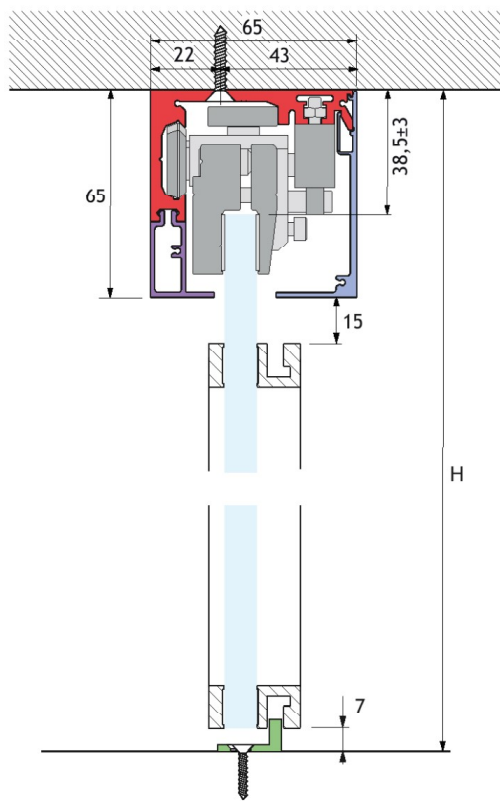
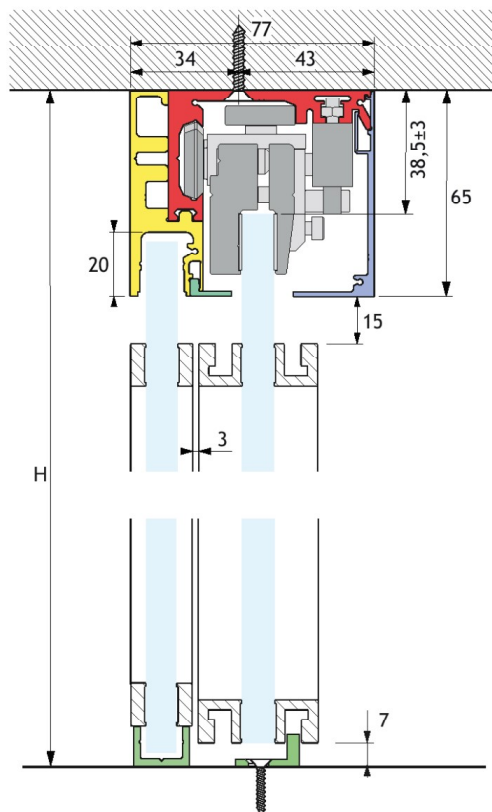
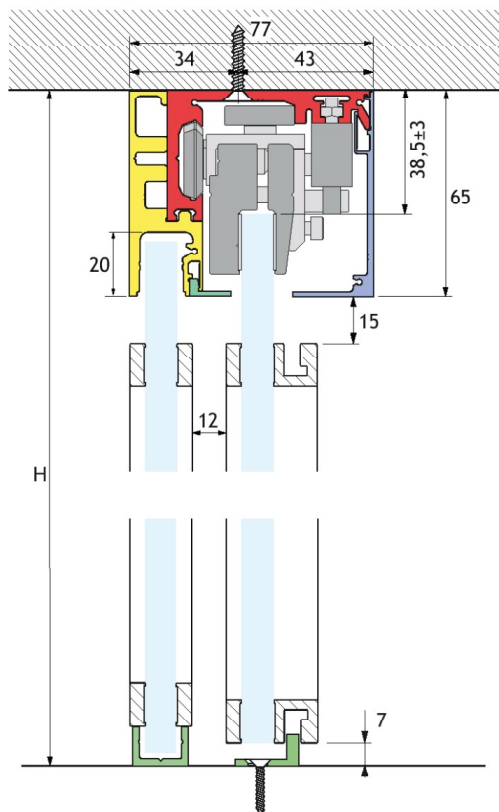

Fissaggio a soffitto con vetro fisso/ceiling fixing with side glass

SISTEMA FORMA + CHEO

fissaggio a soffitto/ceiling fixing

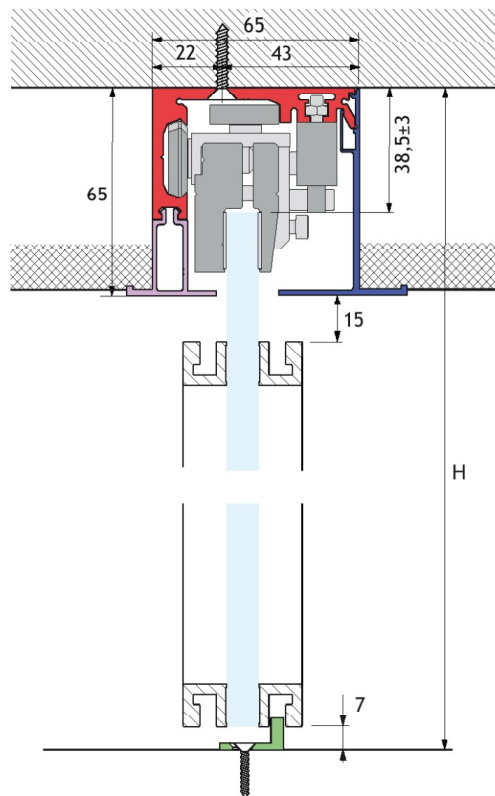
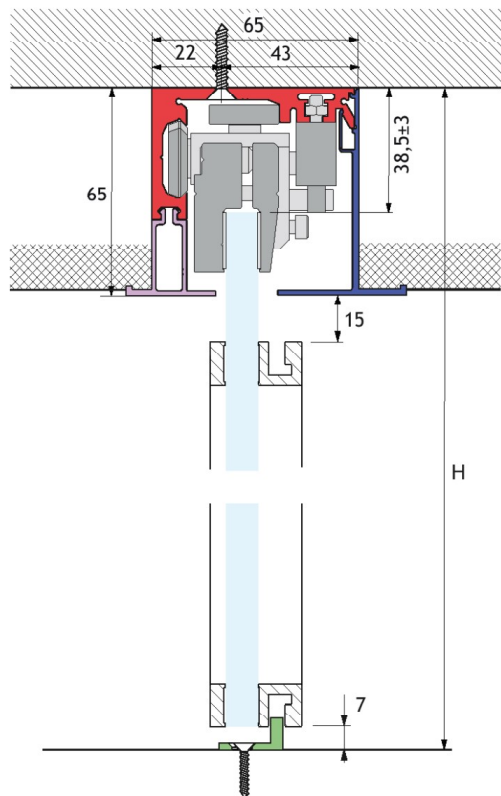

Fissaggio a soffitto nascosto senza vetro fisso/concealed ceiling fixing without side glass

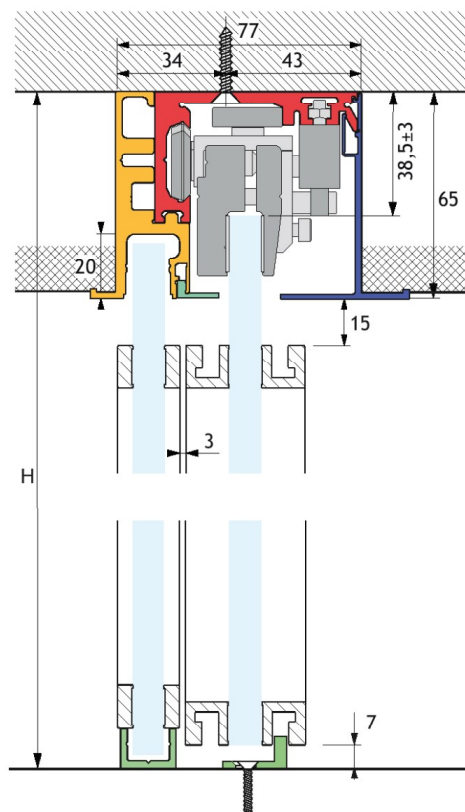
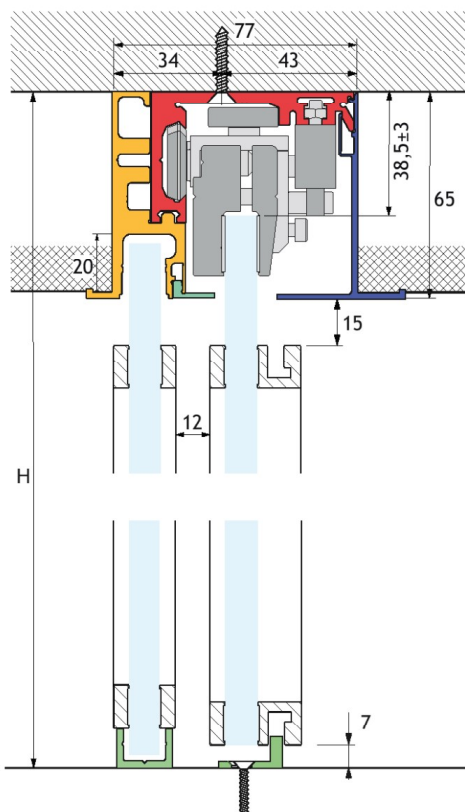

Fissaggio a soffitto nascosto con vetro fisso/concealed ceiling fixing with side glass

SISTEMA FORMA + CHEO

fissaggio a soffitto/ceiling fixing

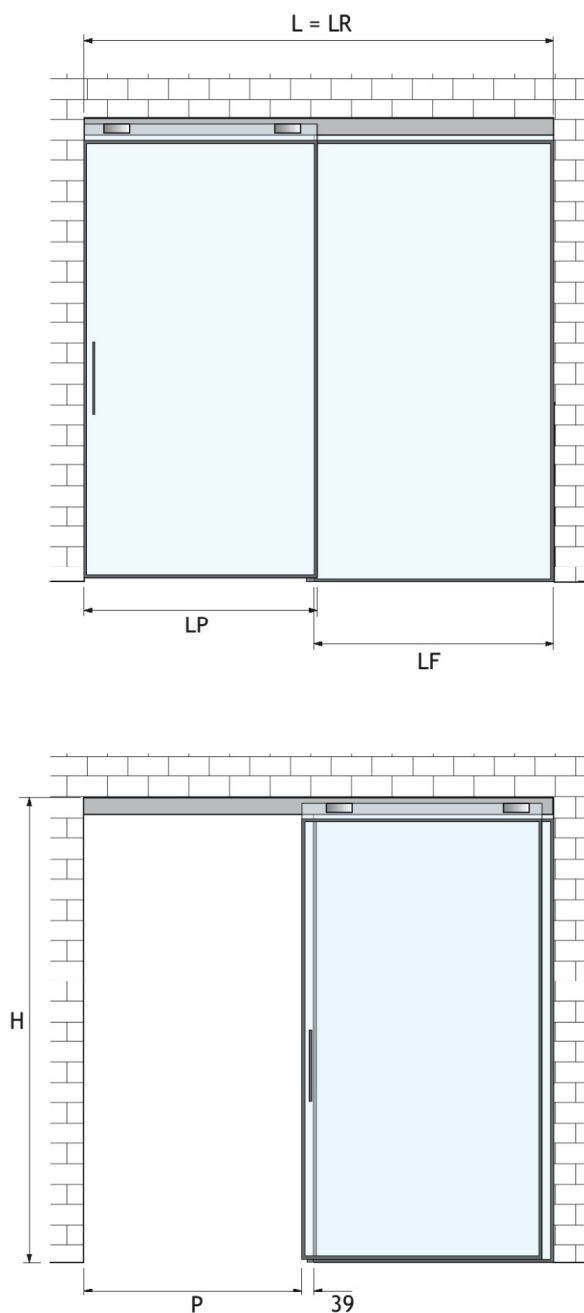

Dimensionamento della porta e del binario fissaggio a soffitto anta singola con vetro fisso	Glass and track sizing, ceiling fixing, single door with side panel
Larghezza porta $LP = (L / 2) + 13 \text{ mm}$	Door width $LP = (L / 2) + 13 \text{ mm}$
Lunghezza rotaia $LR = L$	Track length $LR = L$
Larghezza del vetro fisso $LF = (L / 2)$	Side panel width $LF = (L / 2)$
Misura del passaggio $P = (L / 2) - 39 \text{ mm}$	Passage width $P = (L / 2) - 39 \text{ mm}$
Altezza porta = $H - 45,5 \text{ mm}$ Altezza vetro fisso = $H - 55 \text{ mm}$	Door height = $H - 45,5 \text{ mm}$ Side panel height = $H - 55 \text{ mm}$

SISTEMA FORMA + CHEO

fissaggio a soffitto/ceiling fixing

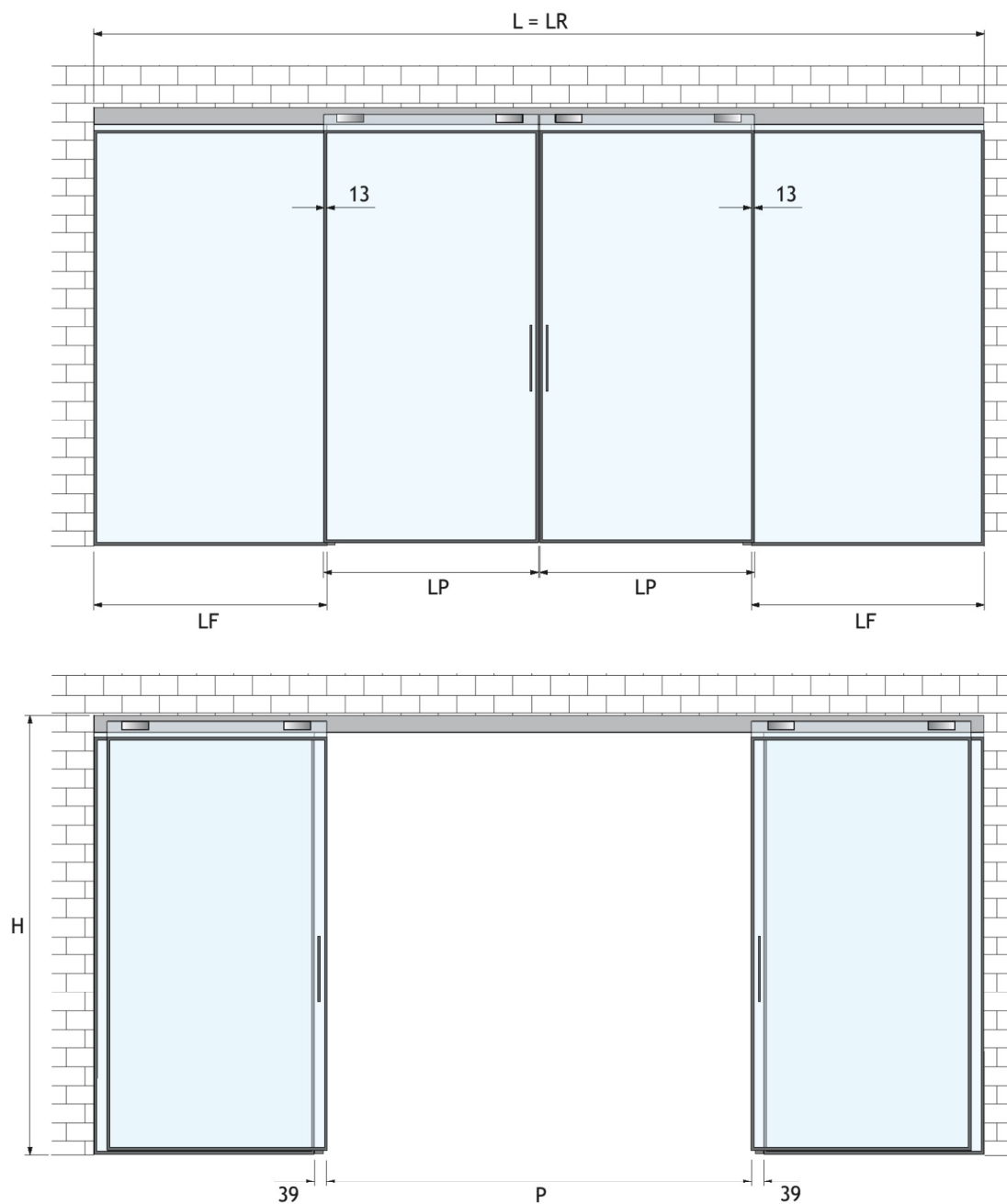

Dimensionamento della porta e del binario fissaggio a soffitto anta doppia con vetro fisso	Glass and track sizing, ceiling fixing, double door with side panel
Larghezza porta $LP = (L / 4) + 13$ mm	Door width $LP = (L / 4) + 13$ mm
Lunghezza rotaia $LR = L$	Track length $LR = L$
Larghezza del vetro fisso $LF = (L / 4)$	Side panel width $LF = (L / 4)$
Misura del passaggio $P = (L / 2) - 78$ mm	Passage width $P = (L / 2) - 78$ mm
Altezza porta = $H - 45,5$ mm Altezza vetro fisso = $H - 55$ mm	Door height = $H - 45,5$ mm Side panel height = $H - 55$ mm